

# AGENDA ITEM 6

## APPENDIX I

2017/0008/DET

PLANS

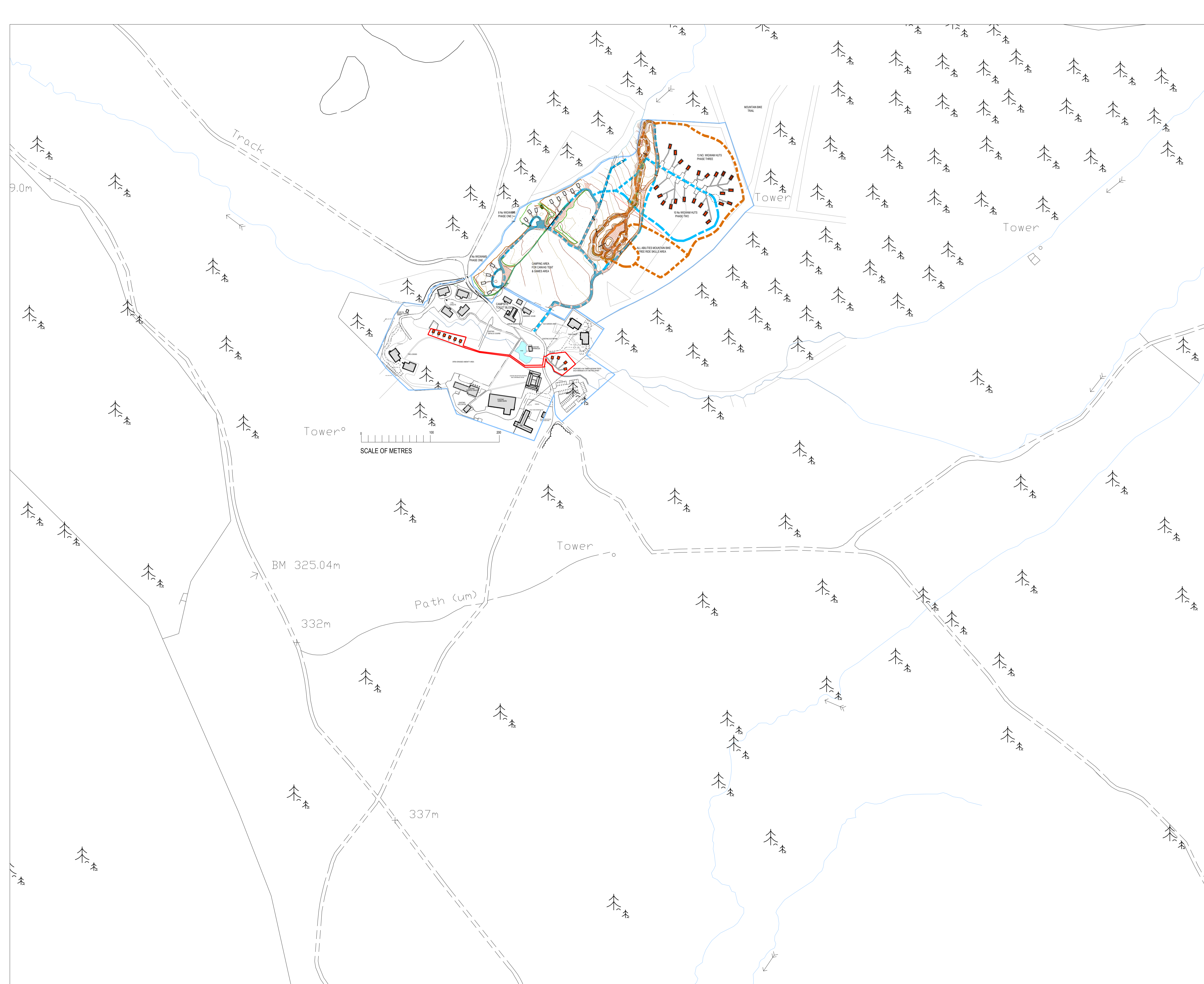
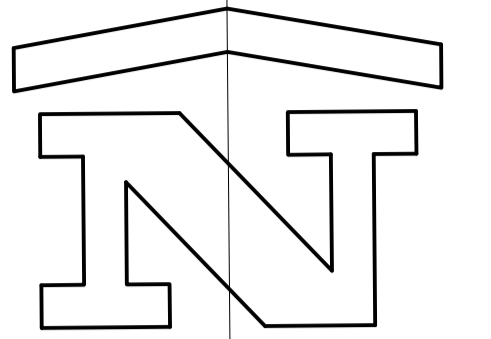

**Bracewell Stirling CONSULTING**

● 5 NESS BANK, INVERNESS, IV2 4SF TEL: 01463 233760 FAX: 01463 233785  
○ 38 WALKER TERRACE, TILLCOULTRY, FK13 6EF TEL: 01259 750301 FAX: 01259 752365

**10 no Temporary Wigwams**  
Badaguish Outdoor Centre, Aviemore.  
Speyside Trust

Location Plan

SCALE	1:2500	DATE	Nov 15	BY	KM
			Planning		DWG SIZE
DWG NO	4111 / LOC			REV	A3

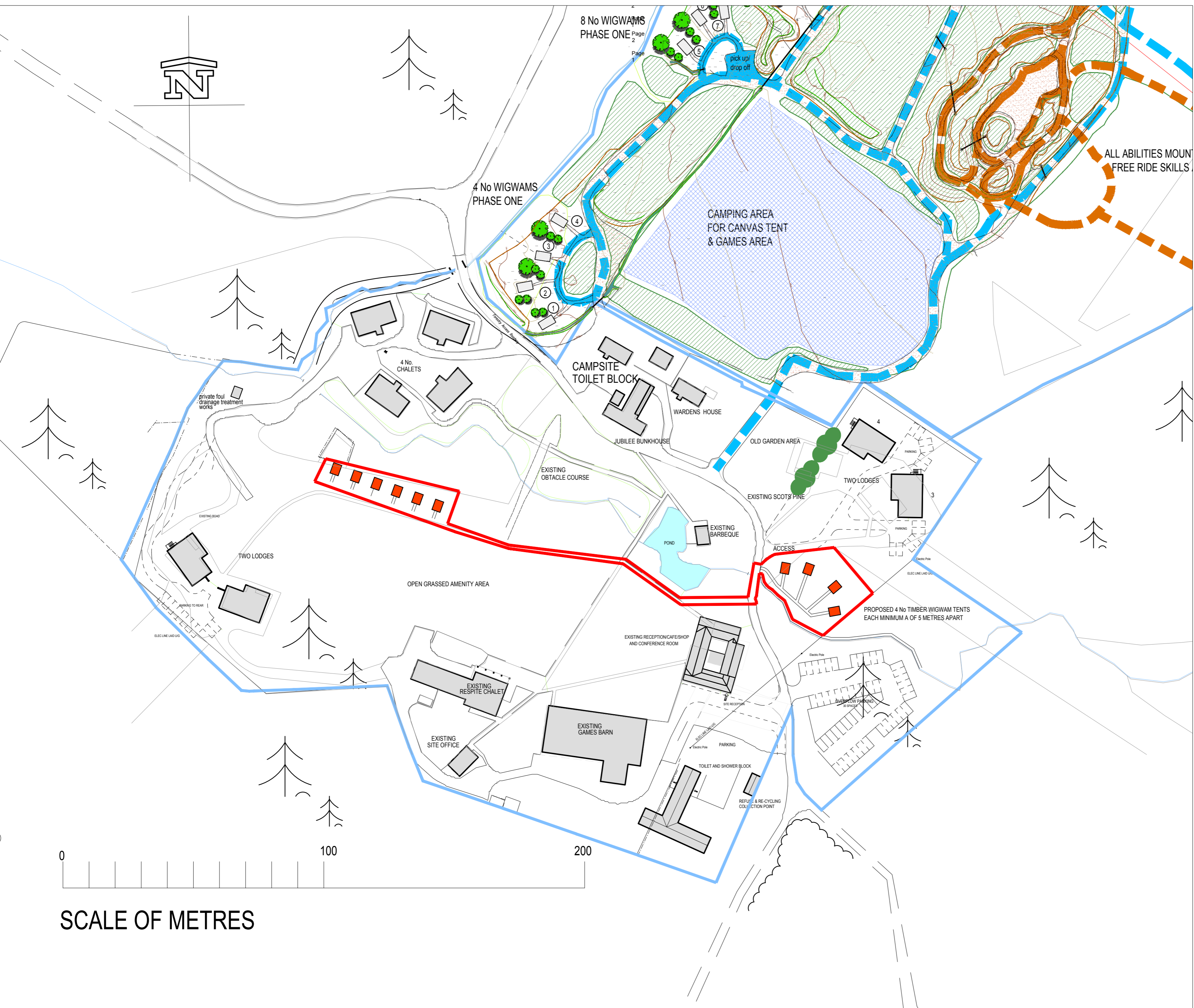

SCALE OF METRES

Rev A Up to date site plan of wider site added. Dec 15  
 REVISIONS

**Bracewell Stirling CONSULTING**

● 5 NESS BANK, INVERNESS, IV2 4SF  
 TEL: 01463 233760 FAX: 01463 233785

○ 38 WALKER TERRACE, TILlicOUNTRY, FK13 6EF  
 TEL: 01259 750301 FAX: 01259 752365

**10no. Tempory Wigwams  
 Badaguish Outdoor Centre, Aviemore  
 Speyside Trust**

Site Layout	
SCALE 1:1000	DATE 11/11/15 PLANNING
DWG NO 4111 / 062	BY KM DWG SIZE A2 REV A



REV	DATE	DESCRIPTION	DRN	CHD
<h2 style="margin: 0;">Bracewell Stirling</h2>				
●		38 WALKER TERRACE, TILlicOUNTRY, FK13 6EF TEL: 01259 750301	●	
○		5 NESS BANK, INVERNESS, IV2 4SF TEL: 01463 233760	○	
<p>10no. TEMPORARY WIGWAMS BADAGUISH OUTDOOR CENTRE, AVIEMORE SPEYSIDE TRUST</p>				
<p>TITLE WIGWAM SITE PHOTOS</p>				
SCALE		DATE	BY	
NTS		---	---	
		PURPOSE	PLANNING	PAPER
				A3
DWG NO.-REV		4111-002		