

AGENDA ITEM 10

APPENDIX I

2015/0379/DET

ILLUSTRATIONS

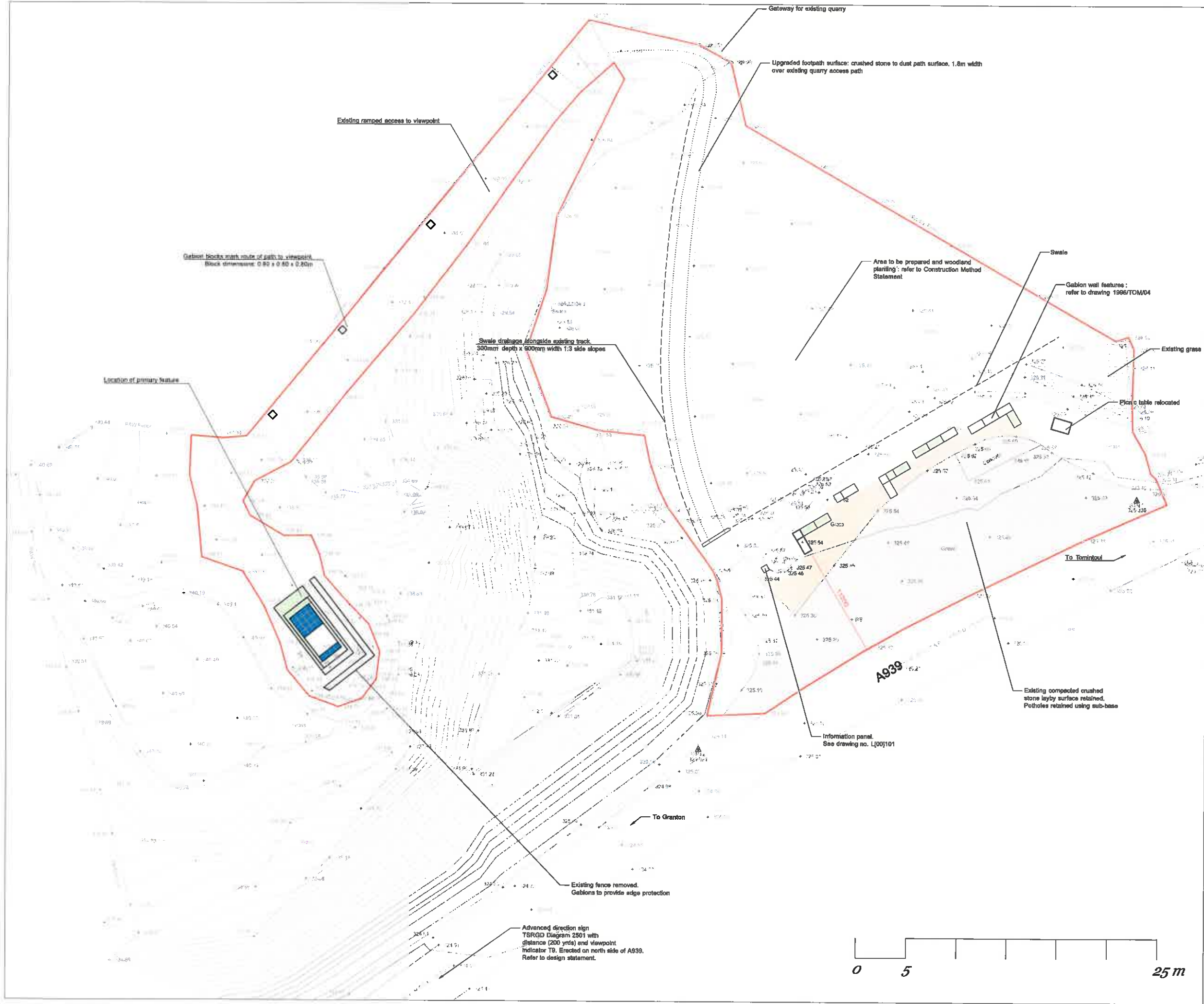

Refer to Construction Method Statement for all details of:

- Working methods
- Environmental Protection
- Public Access
- Soil strip
- Excavations
- Footpath and swale works
- Vegetation reinstatement
- Woodland Planting

- Key**
- Area of new layby surface of compacted crushed stone
 - Existing layby area of compacted crushed stone; repair potholes with sub-base
 - Gabions - standard stone finish
 - Gabions - turfed finish
 - Gabions - stone slab finish

© Crown copyright and database rights 2016 Ordnance Survey 100049261

PLANNING

Rev	Description	Date	Author	Checked
1	Issue for planning	11/08/2016	AB	AB
2	Revised drawing	11/08/2016	AB	AB
3	Final drawing	11/08/2016	AB	AB

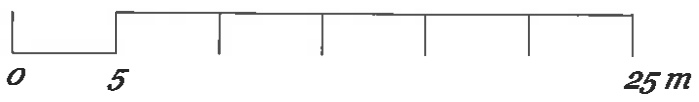

Project No: 10000

Client: Scottish Sports Centre

Location: Glasgow City, Scotland

Scale: 1:1000

Drawing No: L100101

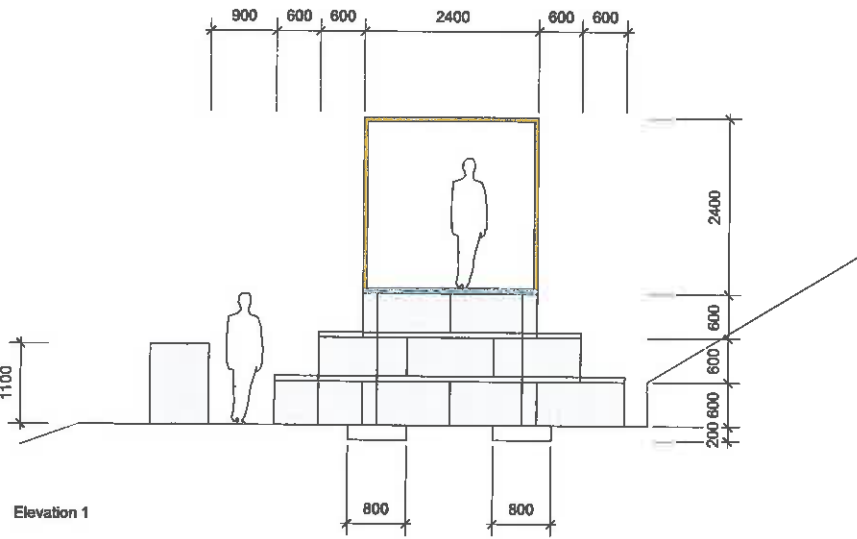

Elevation 1

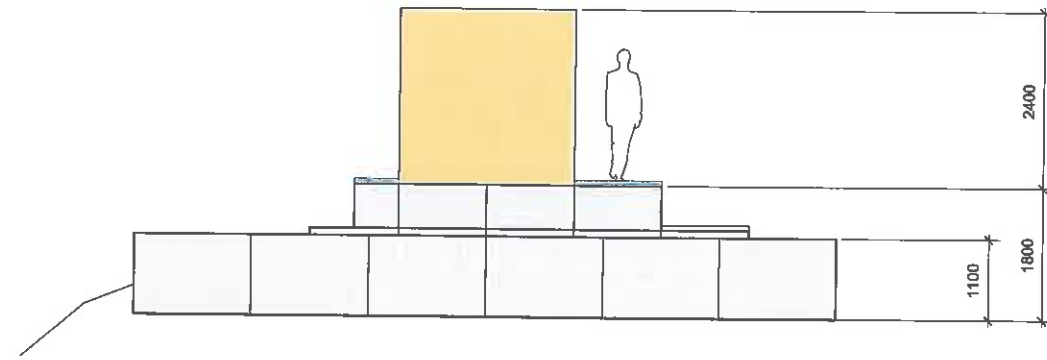

Elevation 2

Proposed Plan

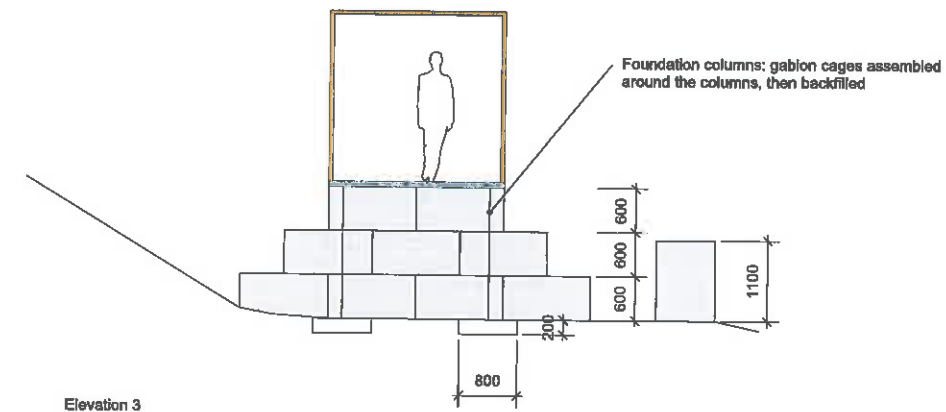
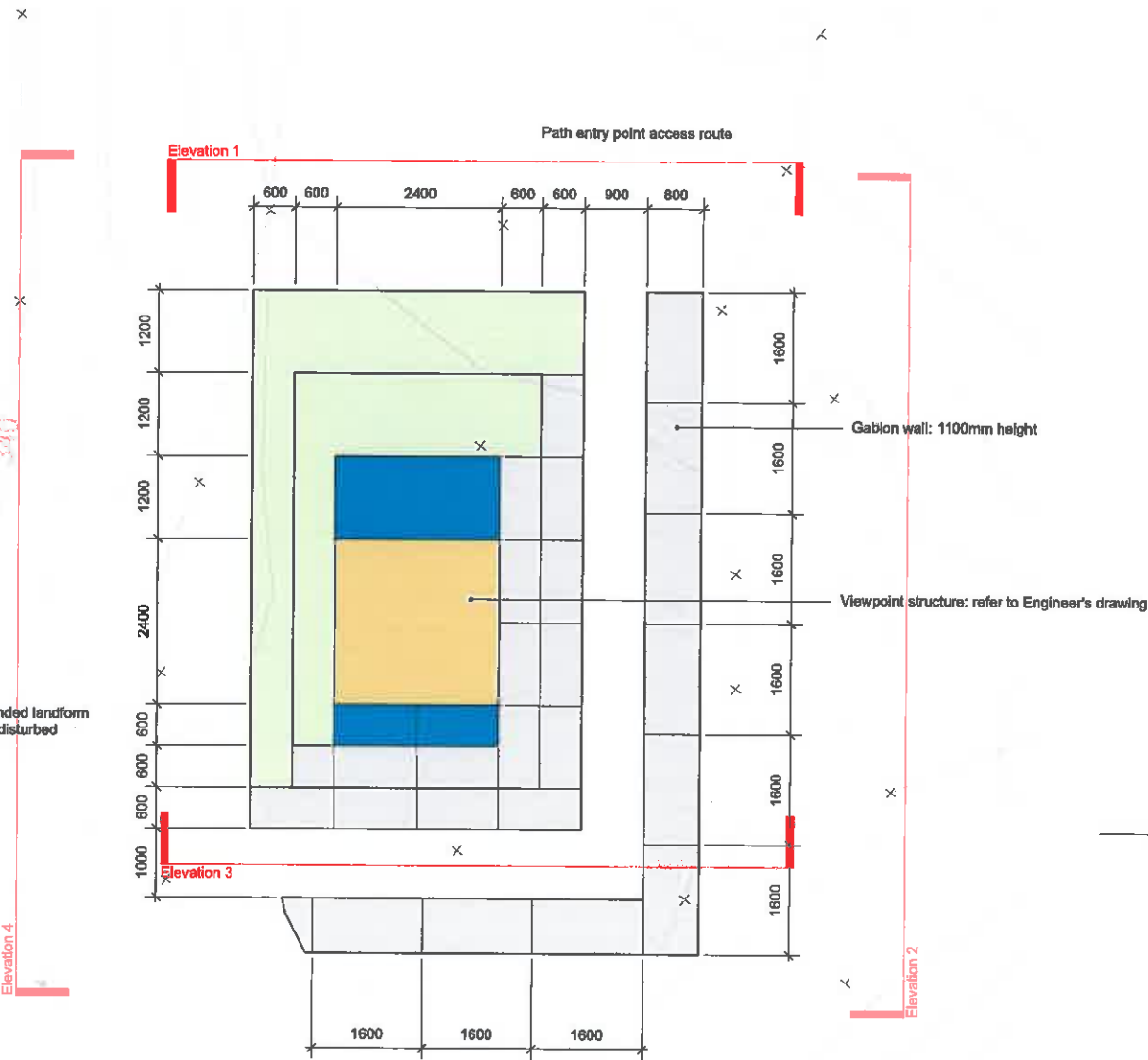

Elevation 3

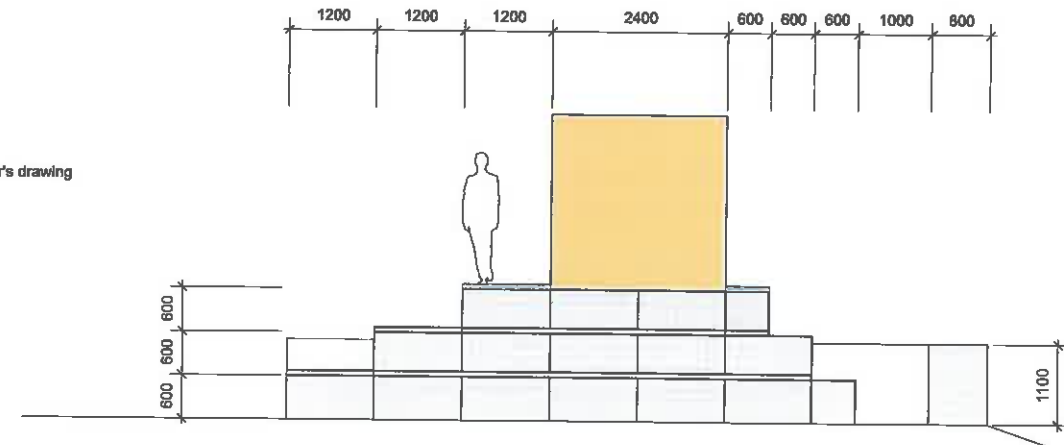

Elevation 4

- KEY**
- Standard Gabion Finish
 - Turfed Gabion Finish
 - Stone Slab Finish

Specifications for Gabions

Galfan finished mild steel welded mesh. 5mm gauge wire. 75 x 75mm wire mesh size. Polyester powder coated black.

All horizontal lid joints to have galvan oated helicals.

Stone infill sourced from adjacent Craighaulk quarry; size minimum 100mm dimension. Selected facing stones to be exposed front and top faces, to be hand sorted and placed on natural bedding, tight to the gabion face and with fair face outwards. Other parts of gabion not visible shall be filled without hand placement.

Gabions to be seated on firm, free-draining ground, assumed to be of quarry waste material in-situ. Excavate soft ground and replace with crushed stone if required.

Turfed gabions to have front face of hand-placed stone and rear infill of random 100mm minimum stone to half depth of the gabion. Porous geotextile lined pocket of silts topsoil 300mm depth behind the facing stone, well firmed into place, with silts turves laid immediately below the gabion lid. Water well on completion.

Seating gabions to be fair-faced stone filled to top. 500 x 60 x 5mm galvanised steel battens placed in top, with welded dowels projecting upwards to fit plywood template. Fix gabion lid. Lay 1200 x 600 x 70mm cast-in-place slab pre-drilled in base (holes filled with epoxy resin anchor compound) to template pattern, engaging slab onto the dowels and levelling with adjacent slabs. Edges of cast-in-place slab to have pencil rounded arrises.

REVISION	NOTES	DATE	CHECKED
		20/01/2016	NJB

PLANNING

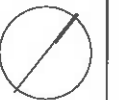

CAIRNGORM NATIONAL PARK
Scottish Scenic Routes
Craighaulk Quarry, Tomintoul

SCALE 1:50 @ A1

Viewpoint Feature

DRAWING NO: 1996/TOH/03

3A Forest Road
Strling, FK9 3JH
T: 01786 445446
F: 01786 446441
E: studio@iwha.co.uk

IAN WHITE ASSOCIATES LANDSCAPE ARCHITECTS

GABION WALL FEATURES (1:50)

Plan 1

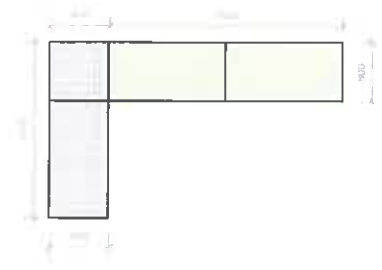

Plan 2



Plan 3

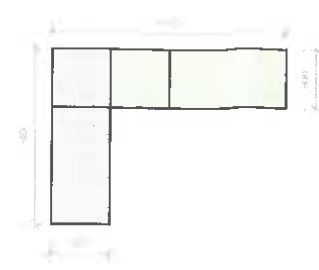

Plan 4



Plan 5

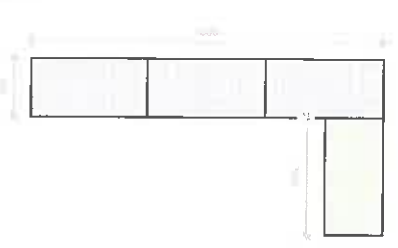

Elevation 1

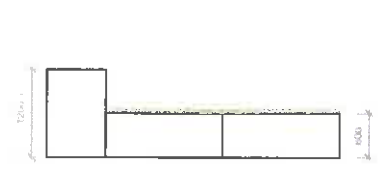

Elevation 2

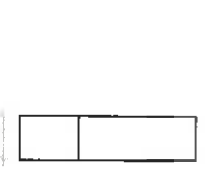

Elevation 3

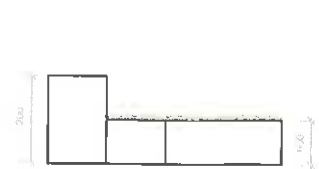

Elevation 4



Elevation 5

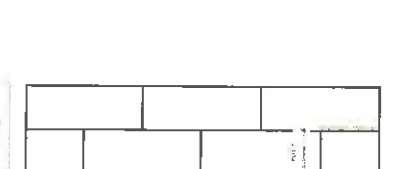

KEY
 Standard Gabion Finish
 Turfed Gabion Finish

INFORMATION PANEL

Elevation (1:10)

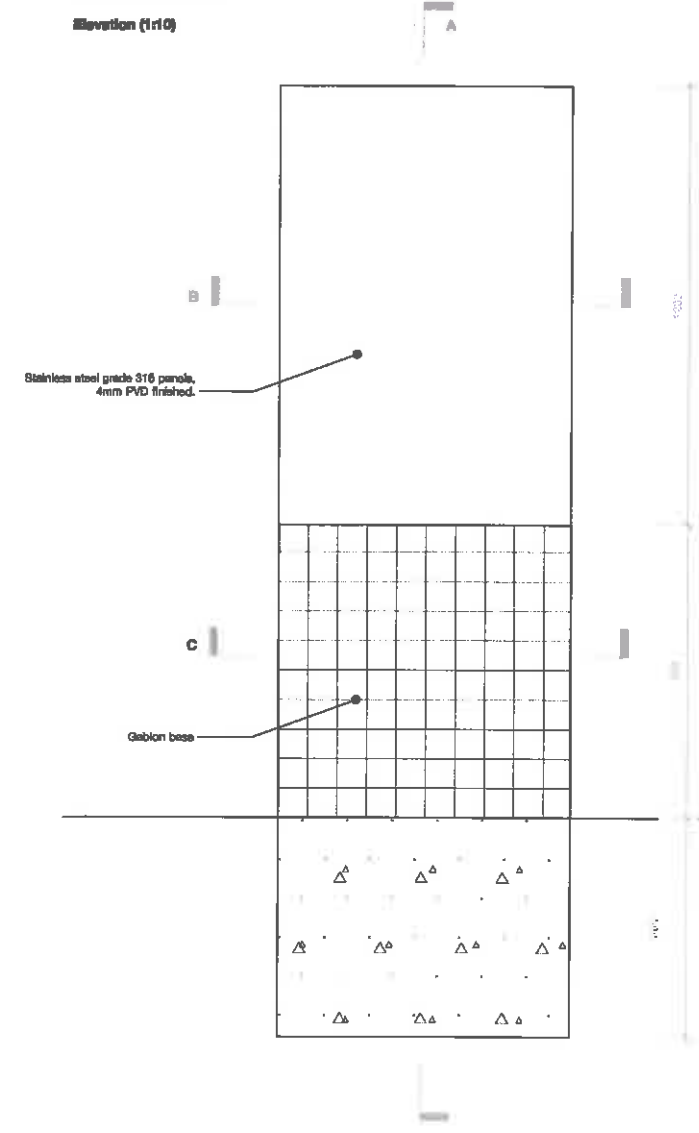

Plan (1:10)

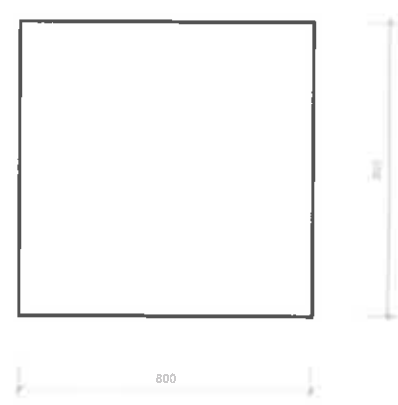

Section A (1:10)

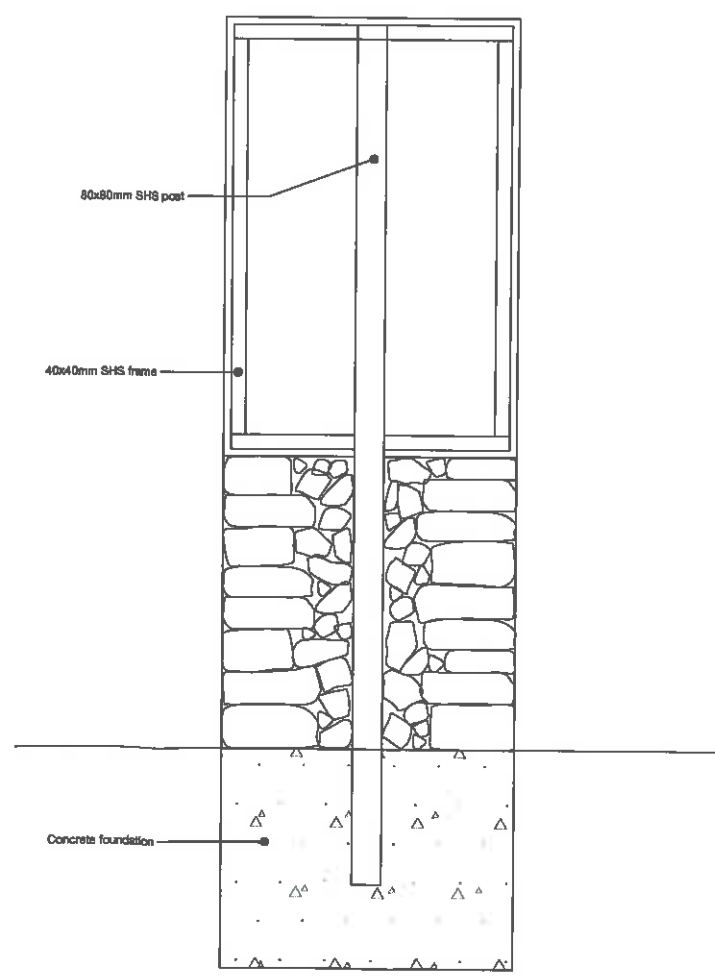

Section B (1:10)

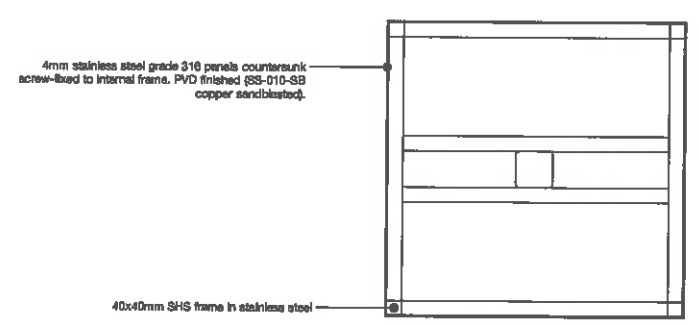

Section C (1:10)

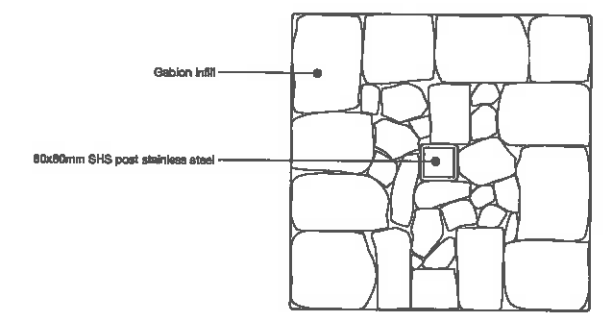

Refer to BS8 / TD8 / OS for gabion specification

REVISION	NOTES	DATE	CHECKED
PLANNING		23/01/2018	NJB

CAIRNGORM NATIONAL PARK
 Scottish Specific Routes
 Craigheadle Quarry, Tomintoul
 SCALE: print as A1
 DRAWING NO: 1004/TDR/04

IAN WHITE ASSOCIATES LANDSCAPE ARCHITECTS
 3A Forrest Road
 Strath, High Lan
 T: 01753 446444
 F: 01753 446441
 i@studio@ianwhite.co.uk

STANDARD GABION BASKET

Elevation (1:10)

Welded steel mesh; 5mm wire with galvan finish. Polyester powder coated black. 75 x 75mm aperture.

Helicoils with galvan finish to all horizontal lid joints.

100 - 200mm stone infill.

Selected hand placed stone to exposed front and top faces. Stone laid with natural bedding, tight to the gabion face and with tight joints; fair face outwards.

Gabions within core of structure to be infilled without hand placing.

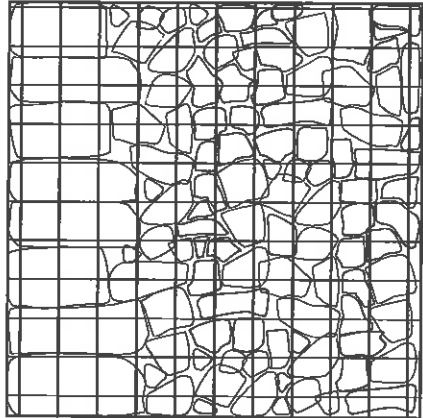

Refer to Drawings

TURF TOP BASKET

Elevation (1:10)

1 - Select hand placed stone to exposed front face; as standard gabions.

2 - Porous geotextile separation membrane containing site topsoil packed into gabion.

3 - Site turf cut from area of viewpoint feature with full depth of topsoil / root zone integral. Soil adjusted to bring turf flush against the gabion mesh lid.

4 - Infill stone 100 - 200mm size.

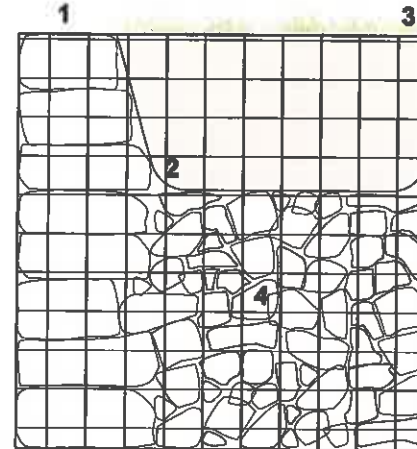

300

STONE SLAB SEATING GABION

Elevation (1:10)

1 - Selected hand placed stone to face of gabion; as above.

2 - 2nr. 500 x 60 x 5mm steel battens with 40mm x 6mm dowels welded to top (2nr. dowels per batten, at 300mm centres.)
Battens placed on top of stone using a plywood template; remove template to fix gabion lid, then replace template to ensure dowels are correct.

3 - 70mm thick caithness slab with pencil radius arrises. 1200 x 600mm size.

4 - 4nr. pre-drilled holes in base of caithness slab, to match plywood template. Fill with epoxy resin before placing slab onto dowels. Adjust level with adjacent slabs.

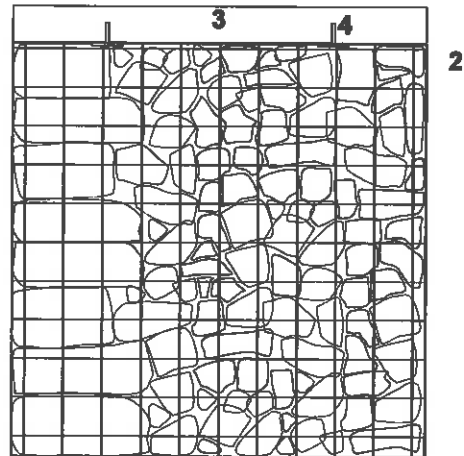

Refer to 1996 / TOM / 03 for gabion specification

REVISION	NOTES	DATE	CHECKED
-	-	25/01/2016	NJB

PLANNING

CAIRNGORM NATIONAL PARK
Scottish Scenic Routes
Craighaulkie Quarry, Tomintoul

SCALE: 1:10 @ A1

Typical Gabion Details

DRAWING NO: 1996/TOM/05

3A Forrest Road
Stirling, FK8 1UH
T: 01786 446446
F: 01786 446441
E: studio@iwastirling.co.uk

**IAN
WHITE
ASSOCIATES
LANDSCAPE
ARCHITECTS**