

# AGENDA ITEM 6

## APPENDIX I

2016/0271/PPP

PLANS AND  
ILLUSTRATIONS

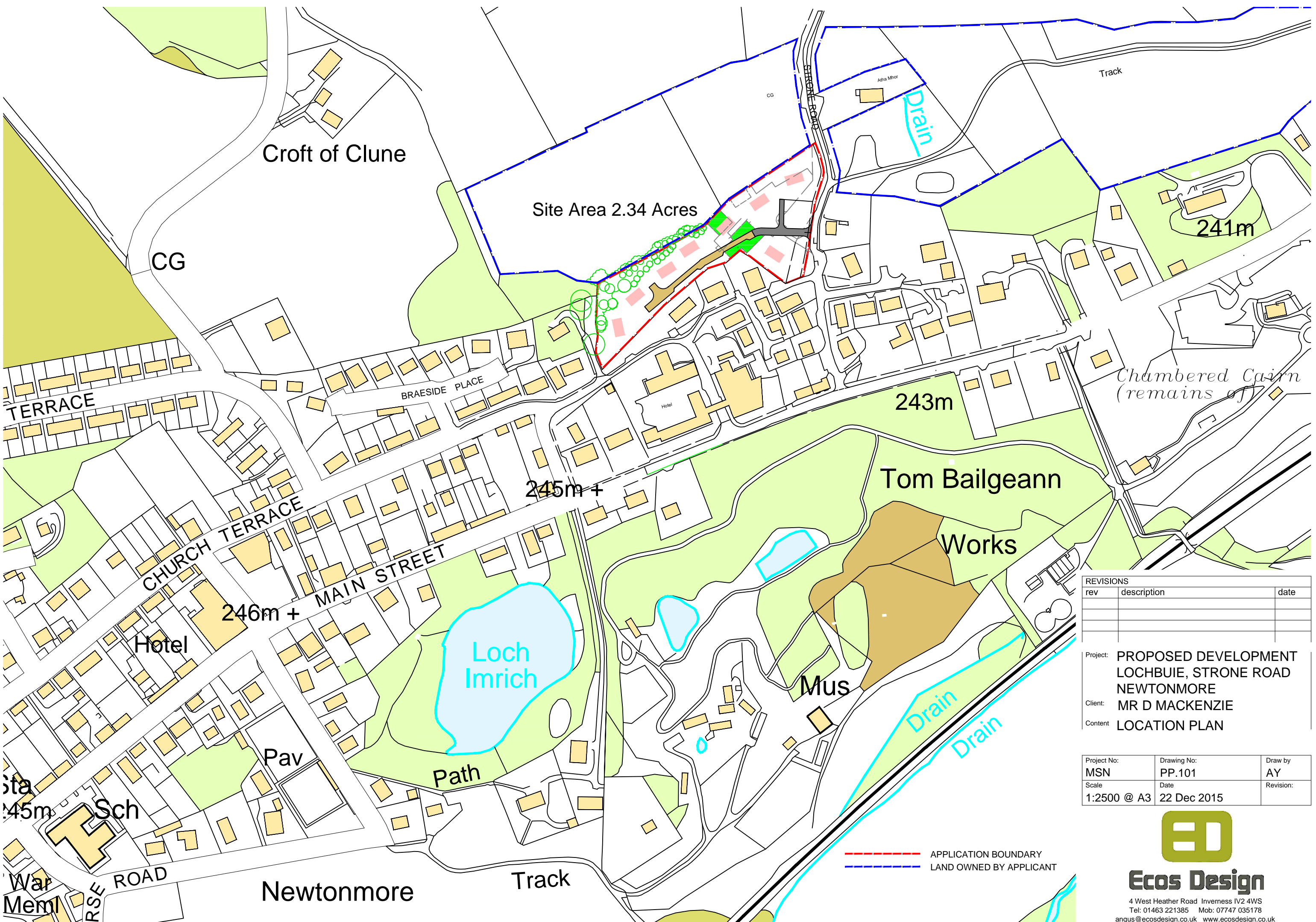

REVISIONS		
rev	description	date

Project: PROPOSED DEVELOPMENT  
 LOCHBUIE, STRONE ROAD  
 NEWTONMORE  
 Client: MR D MACKENZIE  
 Content: LOCATION PLAN

Project No: MSN	Drawing No: PP.101	Draw by: AY
Scale: 1:2500 @ A3	Date: 22 Dec 2015	Revision:



**Ecos Design**

4 West Heather Road Inverness IV2 4WS  
 Tel: 01463 221385 Mob: 07747 035178  
 angus@ecosdesign.co.uk www.ecosdesign.co.uk

NOTES:

APPLICATION AREA: 2.34 ACRES

EXISTING FARM BUILDINGS TO BE REMOVED AND NEW FARM BUILDING ERECTED ON APPLICANT'S LAND, SUBJECT TO SEPARATE APPLICATION.

ACCESS:  
ROAD TO BE UNADOPTED BUT CONSTRUCTED TO HRC ADOPTABLE STANDARDS. NEW BITMAC ACCESS ROAD WITH PERMEABLE BLOCK PAVING CALMING SECTIONS. TURNING HEAD PROVIDED FOR REFUSE AND DELIVERY VEHICLES.

PARKING:  
2 No. PARKING SPACES PROVIDED PER UNIT.

WASTE MANAGEMENT:  
HARDSTANDING ADJACENT TO HOUSES TO ACCOMMODATE 3NO. 240 LITRE WHEELIE BINS.

HARD LANDSCAPING:  
PERMEABLE BRICK PAVING ACCESS DRIVES & PARKING.

PLANTING:  
MIXED INDIGENOUS TREE PLANTING TO AREAS INDICATED.

BOUNDARY TREATMENT:  
PLOT BOUNDARIES TO BE POST & WIRE FENCE WITH MIXED BROAD LEAF HEDGING WHERE INDICATED.

FOUL WATER TREATMENT:  
TAKEN TO PUBLIC SEWER VIA EXISTING DRAINAGE SYSTEM. ALL TO DESIGN OF ENGINEER.

SURFACE WATER:  
TAKEN TO SOAKAWAYS MIN. 5.000M FROM ALL BOUNDARIES & BUILDINGS. COMBINED ROOF & SURFACE WATER SOAKAWAY TO BE LAID UNDER AREA OF BLOCK PAVING ACCESS ROAD. BLOCK PAVING AREAS DESIGNED TO BE PERMEABLE. ALL TO DESIGN OF ENGINEERS.

- APPLICATION BOUNDARY
- LAND OWNED BY APPLICANT

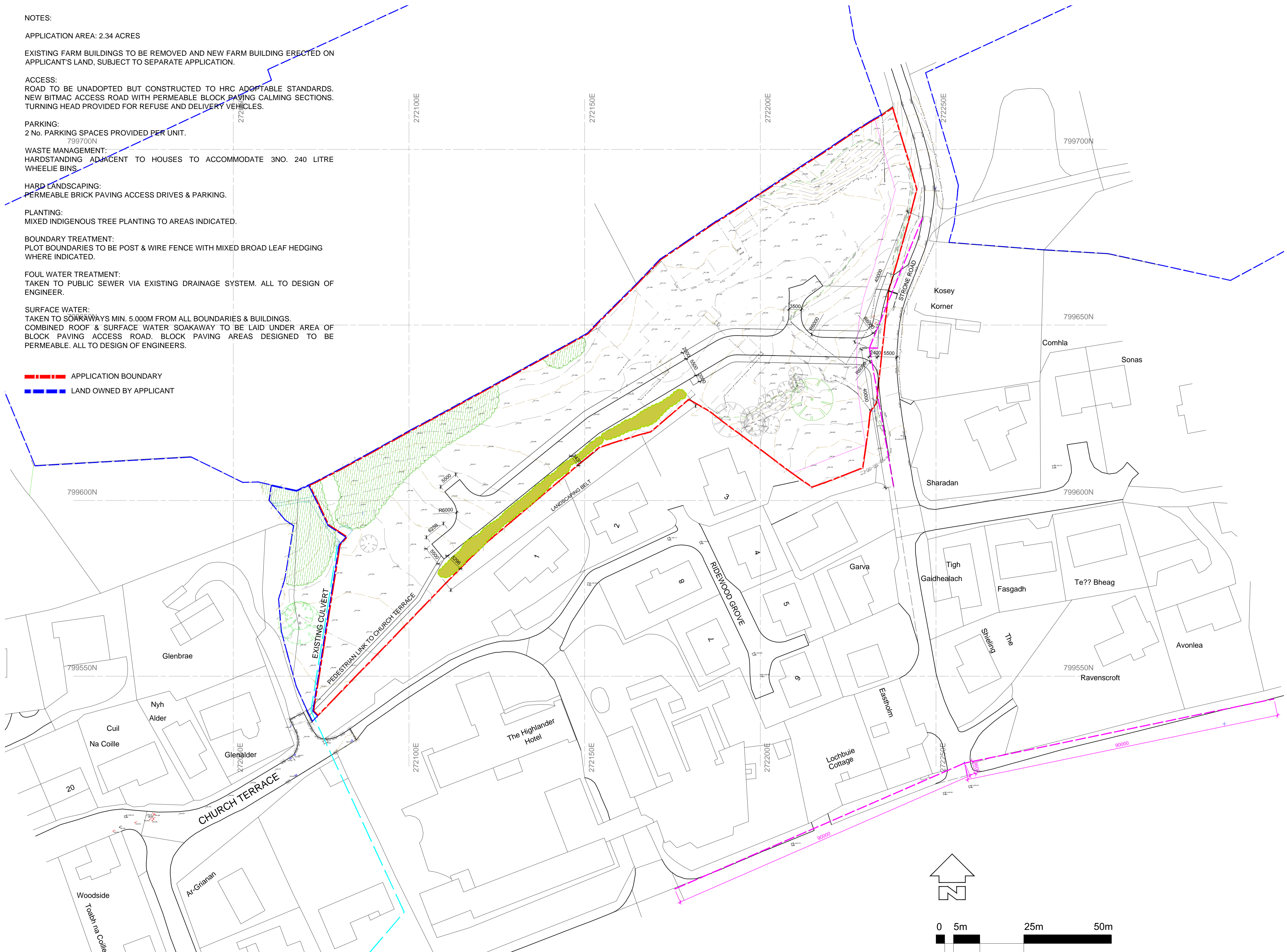

rev	description	date
A	amendments for planning	08.10.16
B	amendments to site boundary	08.02.17

Project: PROPOSED DEVELOPMENT OF 8 HOUSES  
STRONE RD. NEWTONMORE  
Client: MR D MACKENZIE  
Content: PROPOSED SITE PLAN

Project No	Drawing No	Draw by
MSN	PL.103	AY
Scale	Date	Revision
1:250	14.04.2016	B

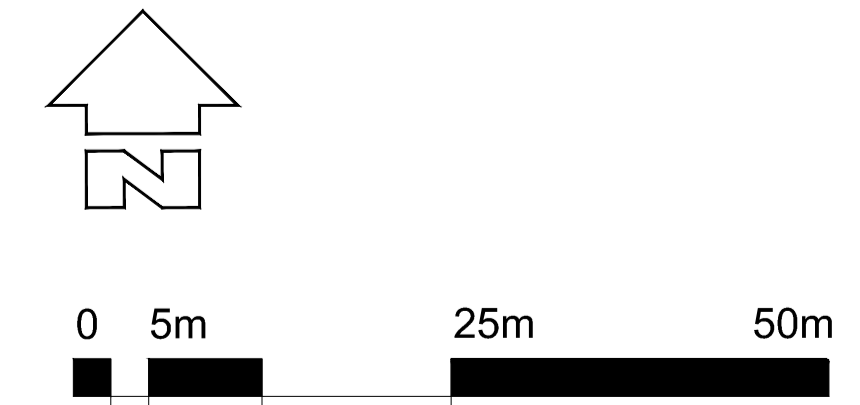

SITE PLAN Scale 1:500

NOTES:

APPLICATION AREA: 2.34 ACRES

EXISTING FARM BUILDINGS TO BE REMOVED AND NEW FARM BUILDING ERECTED ON APPLICANT'S LAND, SUBJECT TO SEPARATE APPLICATION.

ACCESS:  
NEW BITMAC ACCESS ROAD WITH PERMEABLE BLOCK PAVING CALMING SECTIONS. TURNING HEAD PROVIDED FOR REFUSE AND DELIVERY VEHICLES.

PARKING:  
1.5 No. PARKING SPACES PROVIDED PER UNIT.

WASTE MANAGEMENT:  
HARDSTANDING ADJACENT TO HOUSES TO ACCOMMODATE 3NO. 240 LITRE WHEELIE BINS. FLATS TO HAVE COMMUNAL BIN STORES.



HARD LANDSCAPING:  
PERMEABLE BRICK PAVING ACCESS DRIVES & PARKING.

PLANTING:  
MIXED INDIGENOUS TREE PLANTING TO AREAS INDICATED.

BOUNDARY TREATMENT:  
PLOT BOUNDARIES TO BE POST & WIRE FENCE WITH MIXED BROAD LEAF HEDGING WHERE INDICATED.

FOUL WATER TREATMENT:  
TAKEN TO PUBLIC SEWER VIA EXISTING DRAINAGE SYSTEM. ALL TO DESIGN OF ENGINEER.

SURFACE WATER:  
TAKEN TO SOAKAWAYS MIN. 5.000M FROM ALL BOUNDARIES & BUILDINGS. COMBINED ROOF & SURFACE WATER SOAKAWAY TO BE LAID UNDER AREA OF BLOCK PAVING ACCESS ROAD. BLOCK PAVING AREAS DESIGNED TO BE PERMEABLE. ALL TO DESIGN OF ENGINEERS.

-  APPLICATION BOUNDARY
-  LAND OWNED BY APPLICANT

0 5m 25m 50m

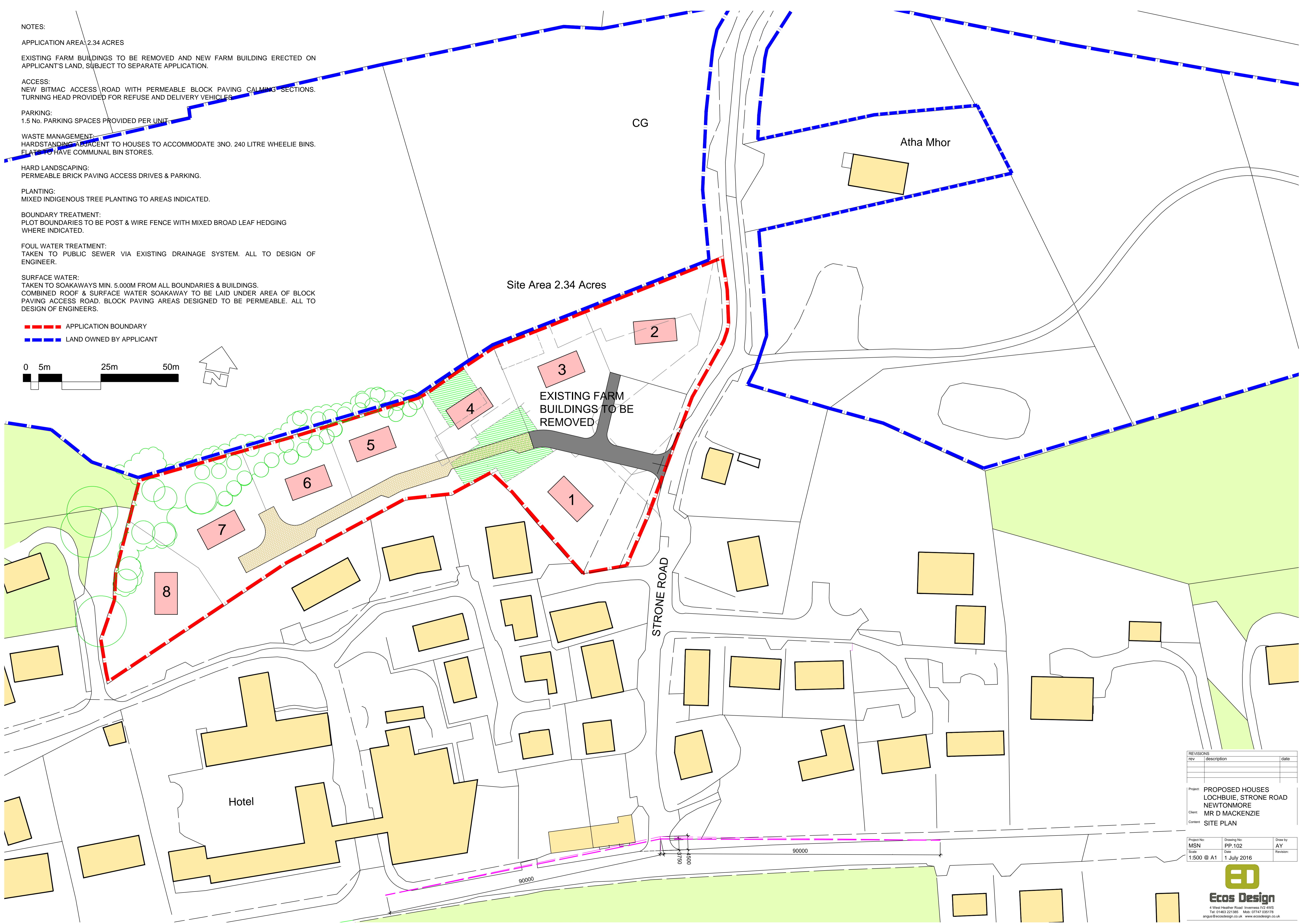

REVISIONS		
rev	description	date

Project: PROPOSED HOUSES  
LOCHBUIE, STRONE ROAD  
NEWTONMORE  
Client: MR D MACKENZIE  
Content: SITE PLAN

Project No: MSN	Drawing No: PP.102	Drawn by: AY
Scale: 1:500 @ A1	Date: 1 July 2016	Revision:



**Ecos Design**  
4 West Heather Road Inverness IV2 4WS  
Tel: 01463 221385 Mob: 07747 035175  
angus@ecosdesign.co.uk www.ecosdesign.co.uk

Photos of Culverted Watercourse as submitted by Agent.

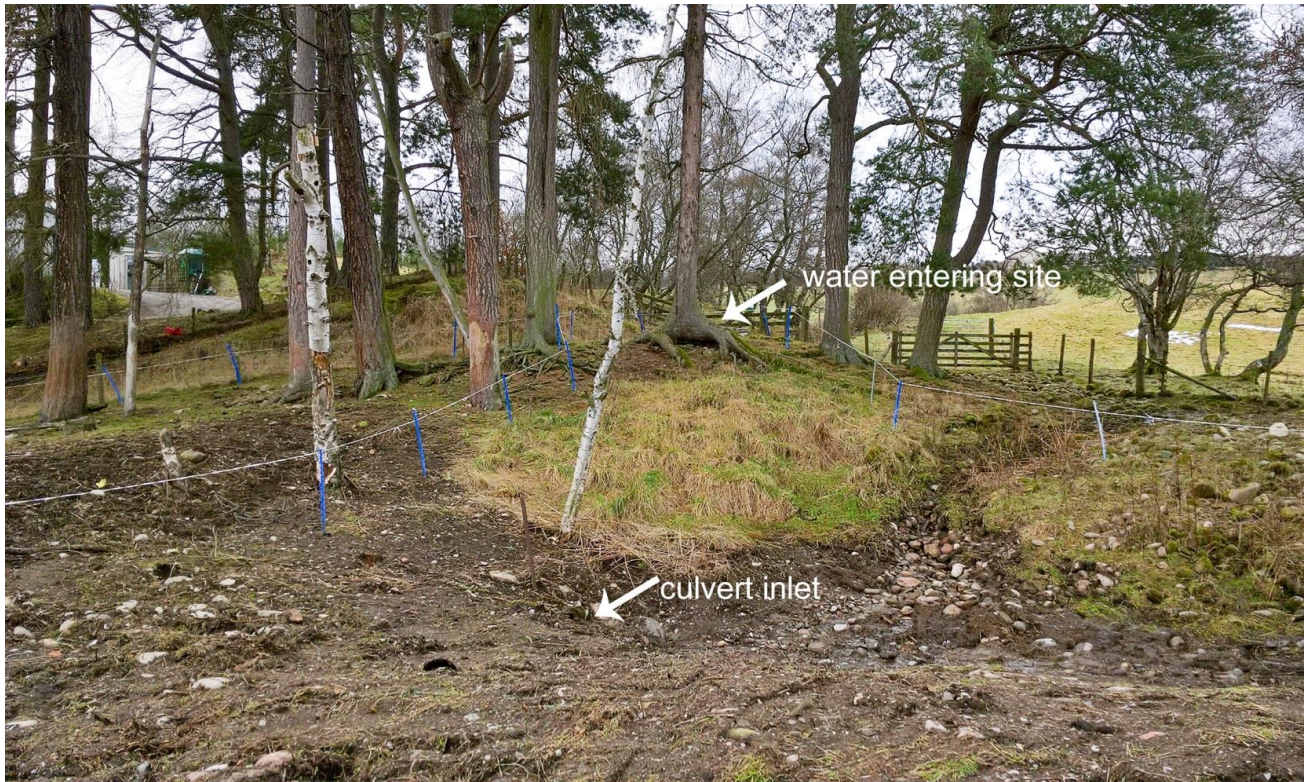

Figure 1: Photograph of watercourse entering application site



Figure 2: Photograph of culvert inlet within application site