

## **Dalwhinnie**

### **Proposals**

**DW/H1:** A site suitable for around six house units opposite and to the north west of the community hall.

**DW/H2:** An infill site at the west end of School Road suitable for around two house units.

**DW/H3:** This site, previously occupied by a hotel, has extant planning permission for 12 units.

**DW/H4:** A site opposite Ben Alder cottages suitable for around six house units.

These sites are affected by the SEPA indicative 1 in 200 year flood risk areas. A detailed flood risk assessment will therefore be required to accompany any development proposals for these sites.

**DW/OS1:** The large community woodland area in the centre of the village should be protected from development.

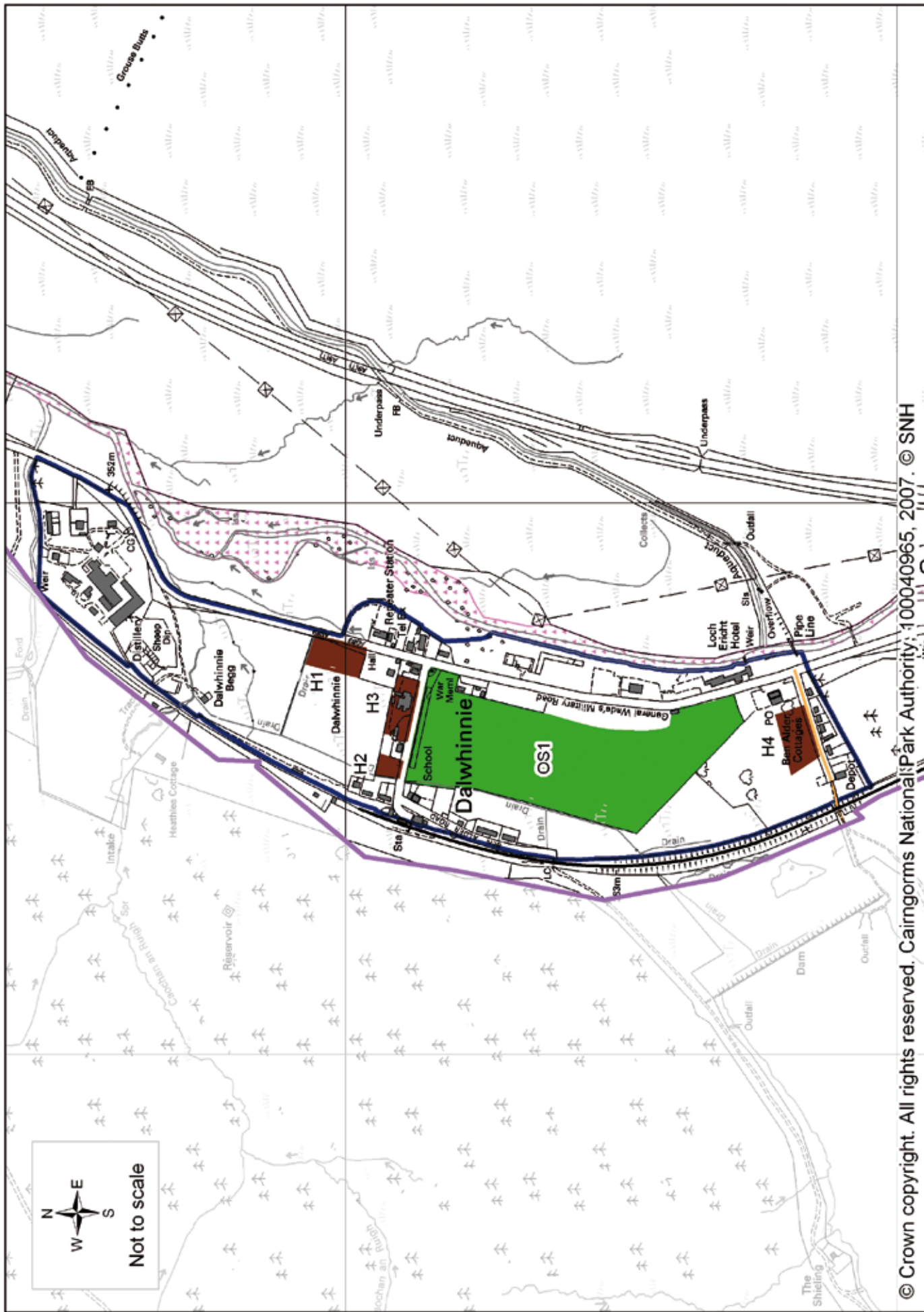

# Dalwhinnie



## Legend

-  Cairngorms National Park
-  Conservation Area
-  Site of Special Scientific Interest
-  Special Protection Area
-  Special Area of Conservation
-  Ramsar Convention Site
-  National Nature Reserve
-  Gardens & Designed Landscapes
-  National Scenic Areas
-  Indicative Settlement Boundary
-  Settlement Boundary

## Settlement Zone Type

-  Community
-  Economic Development
-  Housing
-  Protected Open Space
-  Village Centre

## Proposed Core Path (under consultation)

-  Existing Path
-  Potential New Path